



## EC type-examination certificate

<b>Certificate No.</b>	0617/PU46/2-BP
<b>Notified body</b>	<b>Zentrum der Förder- und Aufzugstechnik Roßwein gGmbH</b> Döbelner Str. 65 A D-04741 Roßwein <b>Ident. No.: 0734</b>
<b>Product / Type</b>	Energy-accumulating buffer with damping of the return movement und non-linear characteristic <b>Type EN 5</b>
<b>Name and address of the Manufacturer</b>	Pleiger Kunststoff GmbH & Co. KG Im Hammertal 51 D-58456 Witten
<b>Name und address of the applicant (Certificate owner)</b>	Elastomer-Technik Nürnberg GmbH An der Kaufleite 20 D-90562 Kalchreuth
<b>Date of submission</b>	2006-03-14
<b>EC-Directive / European Standard</b>	<ul style="list-style-type: none"><li>▪ Lift Directive 95/16/EC</li><li>▪ EN 81-1/2 : 1998 + AC : 1999</li></ul>
<b>Test laboratory</b>	Zentrum der Förder- und Aufzugstechnik Roßwein gGmbH - Prüflaboratorium -
<b>Number and date of test report</b>	0616/PU46/1-BE of 2006-04-06
<b>Statement</b>	The safety component conforms to the directive's essential safety requirements and health requirements for the respective scope of application stated of the annex to this EC type-examination certificate.
<b>Certificate date</b>	2006-04-10
<b>Annex</b>	Annex to the EC type-examination certificate no. 0617/PU46/2-BP

Zentrum der Förder- und Aufzugstechnik  
Roßwein gGmbH  
- Zertifizierungsstelle -

Prof. H. Patzelt  
Head of the  
Certification Body

DI Th. Meyer  
Editor

## Annex to the EC type-examination certificate No. 0617/PU46/2-BP

### 1 General Information

#### 1.1 Scope of application

Application with elevators by Lift Directive 95/16/EC and harmonised European Standard EN 81-1/2

1.1.1	max. rated speed:	1,25 m/s
1.1.2	max. hitting speed:	1,44 m/s
1.1.3	min. mass:	600 kg
1.1.4	max. mass:	1.707 kg

#### 1.2 Allowed ambient conditions

(according to manufacturer's instructions)

1.2.1	Temperature range:	-40°C to +80°C, continuous use up to +50°C
1.2.2	Humidity:	Max. 70% relative humidity at room temperature, avoid continuous contact with water, no effect of chemical substances
1.2.3	Contamination:	Oil-compatible and grease-compatible, protect against acids and leaches

#### 1.3 External signs of the buffer

1.3.1	Dimensions:	Diameter: 125 mm Height: 150 mm
1.3.2	Material:	ETN <sup>®</sup> - Cell-PU
1.3.3	Kind of fixing:	Style A: Circular steel mounting plate with central hole for screw fitting Ø 17 mm Style B: Quadratic steel mounting plate with 4 holes for screw fittings Ø 17 mm Style C: Oval steel mounting plate with 2 holes for screw fittings Ø 14 mm
1.3.4	Marking:	CE marking, Certificate owner („ETN“), Type of buffer („EN 5“), Number of the EC type-examination certificate („0617/PU46/2-BP“), Identity number of notified body („0734“)

### 2 Additional remarks

- Deceleration peaks by the single tests to the EC type-examination have appeared no more than 10,0 g<sub>n</sub>.
- The details of the operating instructions for ETN-lift buffers (dated 14 March 2006) are must be noted.
- The EC type-examination certificate and their annex are to be enclosed the drawing no. 06-054 resp. 06-054-A or 06-054-B dated 14 March 2006.
- The EC type-examination certificate may be used in connection with the pertinent annex only.

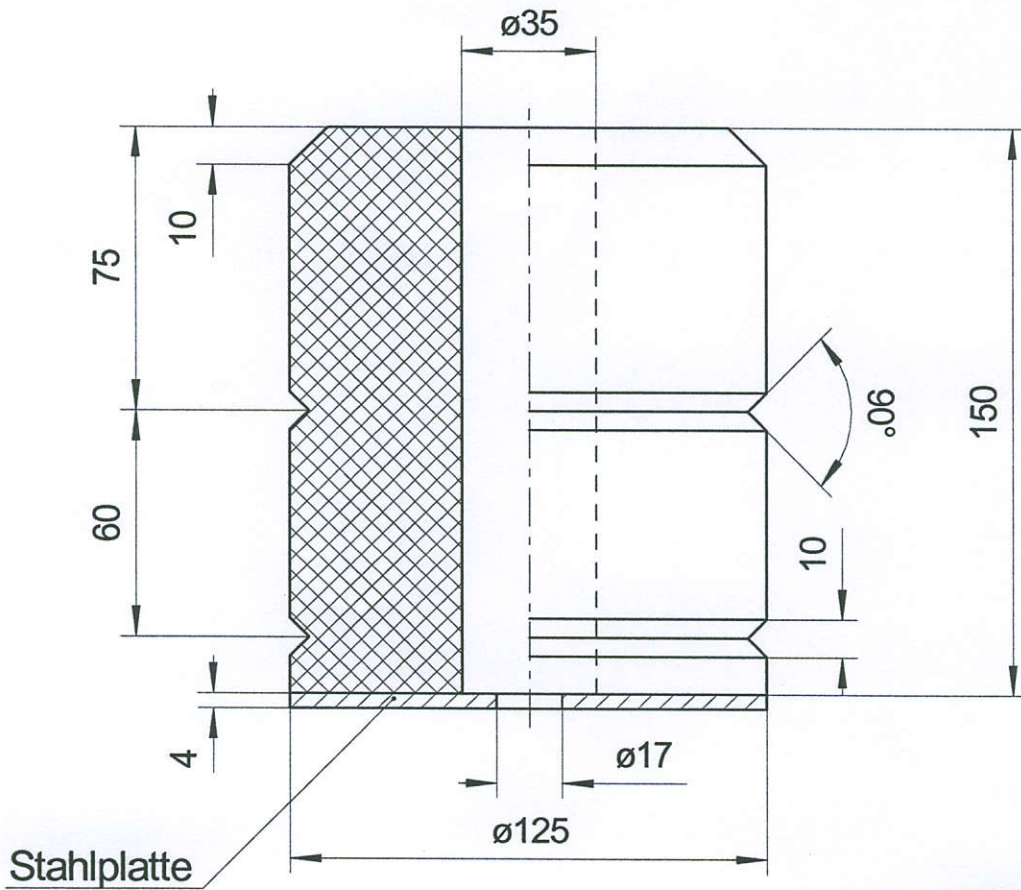

*DI. Meyer*  
 DI Th. Meyer  
 Leiter Prüflaboratorium

05. APR. 2006

Elastomer-Technik Nürnberg GmbH An der Kaufleite 20 D-90562 Kalchreuth						Maßstab 1 : 2	
						Artikel-Nr. 320205	
				Bearb.	Datum	Name	Aufsetzpuffer EN 5 ø 125 x 150 mm
				Gepr.	14.03.06	J. Sperber	
				Norm			
						Zeichnung-Nr. 06-054	
						Blatt	
						Blätter	
Zust.	Änderung	Datum	Name	Ursprung		Ersatz für:	Ersatz durch:

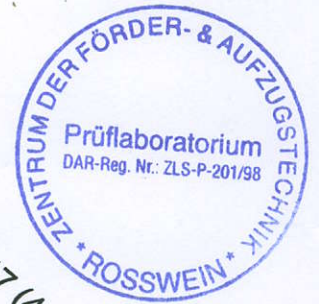
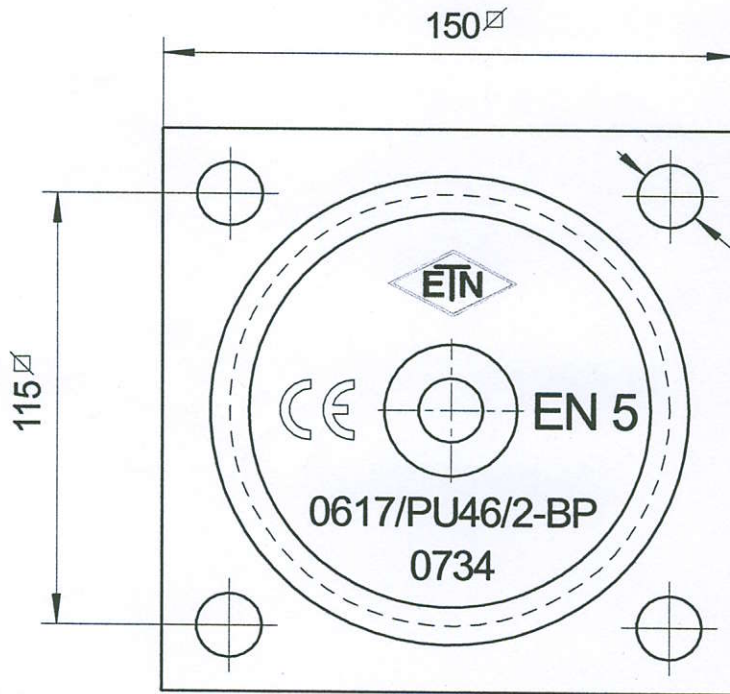
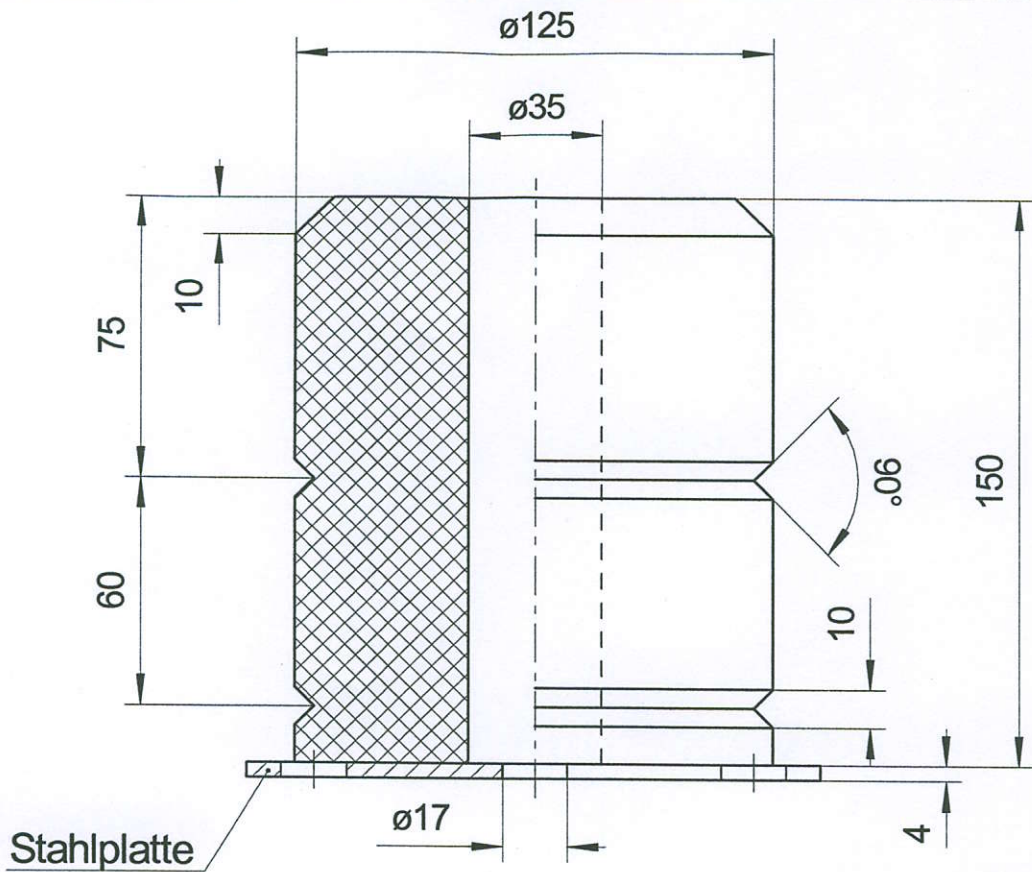

*[Signature]*  
 DI Th. Meyer  
 Leiter Prüflaboratorium

05. APR. 2006

Elastomer-Technik Nürnberg GmbH  
 An der Kaufleite 20  
 D-90562 Kalchreuth



Maßstab 1 : 2

Zust.	Änderung	Datum	Name	Ursprung

	Datum	Name
Bearb.	14.03.06	J. Sperber
Gepr.		
Norm		

**Aufsetzpuffer EN 5**  
 ø 125 x 150 mm, Quad. Platte

Zeichnung-Nr. 06-054-A

Blatt  
 Blätter

Ersatz für: Ersatz durch:

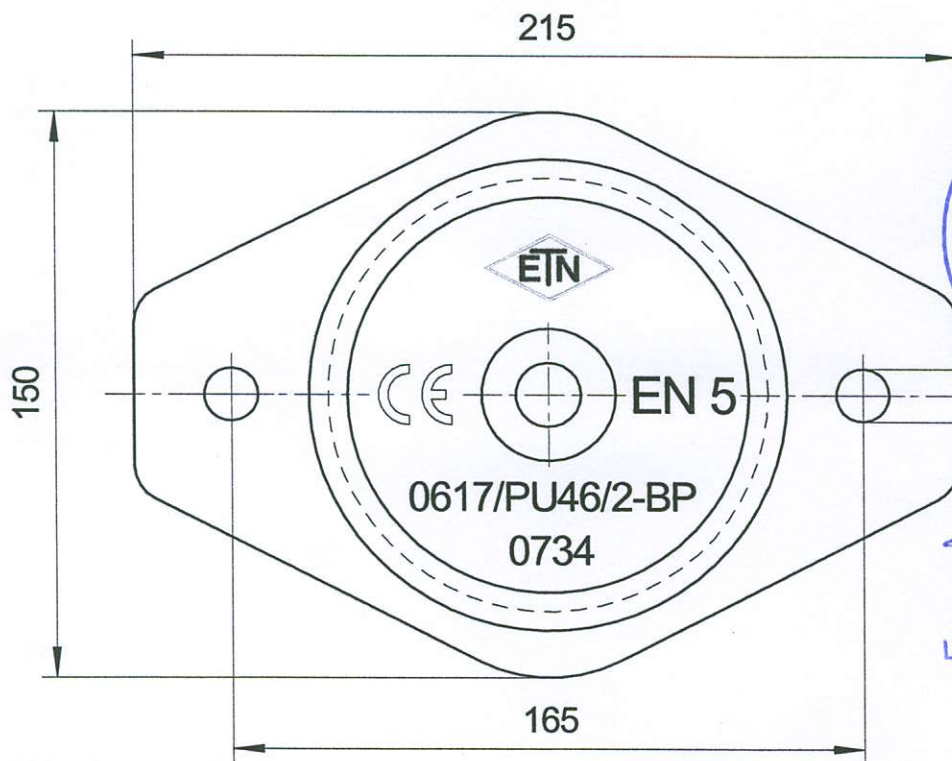
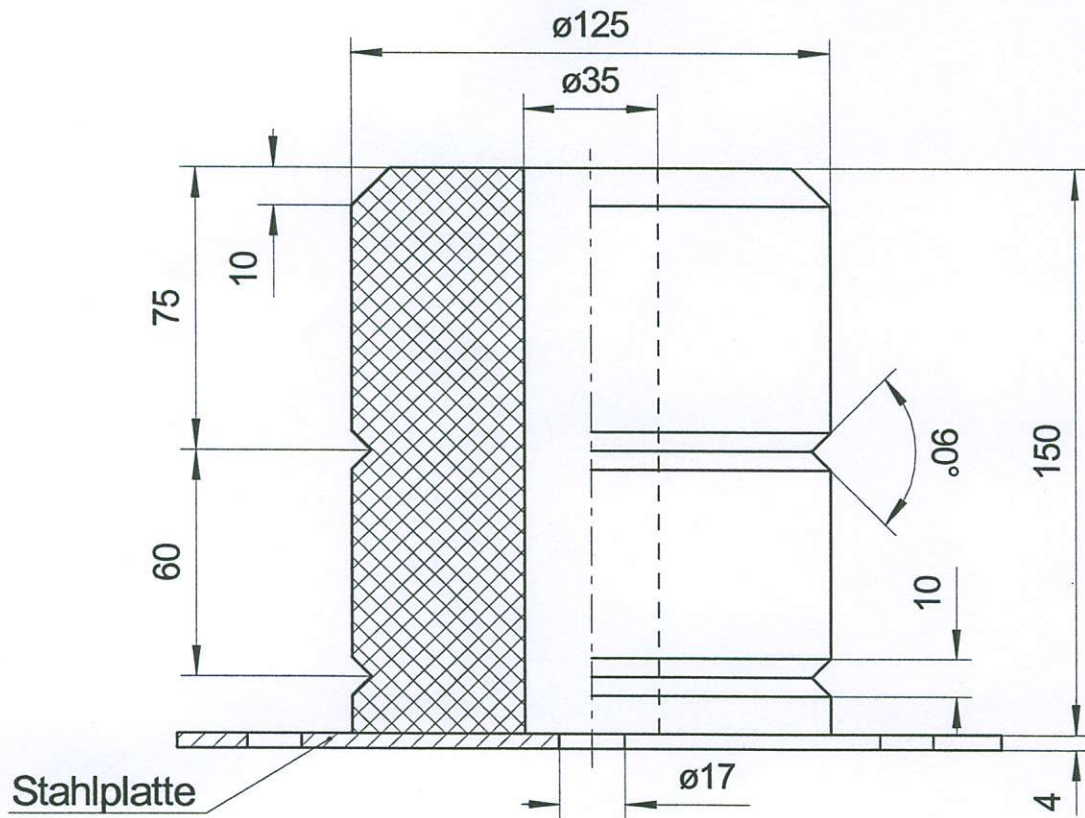

  
 DI Th. Meyer  
 Leiter Prüflaboratorium  
 05. APR. 2006

Elastomer-Technik Nürnberg GmbH  
 An der Kaufleite 20  
 D-90562 Kalchreuth



Maßstab 1 : 2

Zust.	Änderung	Datum	Name	Ursprung

Bearb.	Datum	Name
	14.03.06	J. Sperber
Gepr.		
Norm		

**Aufsetzpuffer EN 5**  
 ø 125 x 150 mm, ovale Platte

Zeichnung-Nr. 06-054-B

Blatt  
 Blätter

Ersatz für:                      Ersatz durch:



## EU - declaration of conformity for ETN-lift buffers

Subject: ETN-lift buffers  
Dimensions and load ranges: see table, page 2

### Materials:

ETN-lift buffer: ETN<sup>®</sup>- Cell-PU  
Mounting plates: steel

We hereby declare that the construction

**Safety component in accordance with annex III number 4 of the directive 2014/33/EU – Energy-accumulating lift buffer with non-linear characteristics**

Harmonised standards used:

**EN 81-1 (1998) + A3: 2009  
EN 81-2 (1998) + A3: 2009**

Nominated test centre for the execution of EC type examination test:

**Zentrum der Förder- und Aufzugstechnik Roßwein gGmbH  
Döbelner Str. 65 A  
D-04741 Roßwein  
Notified body: 0734**

EC type examination test certificate no.:

**see page 2**

Production monitoring by:

**LIFTINSTITUUT B.V.  
Buikslotermeerplein 381  
NL-1025 XE Amsterdam  
Notified body: 0400**

Year of production:

**2016 (details see date stamp)**

Management:

**31/03/2016  
Date**

**Horst Eichler  
Signature**



## EU type examination for ETN-lift buffers

The type examination tests for ETN lift buffers made from Cell-PU have been carried out in accordance with lift directive 95/16/EG. The certificate number records the permissible load ranges for every type of lift buffer. An EU type examination test certificate can be issued for every type of lift buffer on request.

### min./max. load of range [kg] – nominal speed

Dimension [mm]	Buffer type	1,25 m/s
Ø 125 x 150	EN 5	600 1.707
EC type examination test certificate No.: <b>0617/PU46/2-BP</b>		

Specified office: Zentrum der Förder- und  
Aufzugstechnik Roßwein gGmbH  
Döbelner Str. 65 A  
D-04741 Roßwein

page 2